

# EZ-Advancer® Closed System Intermittent Catheter

en

## Instructions for Use

### INDICATIONS FOR USE

The EZ-Advancer® Closed System Intermittent Catheter is intended to drain urine from the bladder.

### CONTRAINDICATIONS

None.

### WARNINGS

- When removing the cap, if the introducer tip is also removed, urinary tract infection (UTI) risk could be heightened as the tip is designed to protect the catheter from potential pathogens.
- Any serious incident that occurs in relation to the device should be reported to the manufacturer.

### CATHETER COMPONENTS

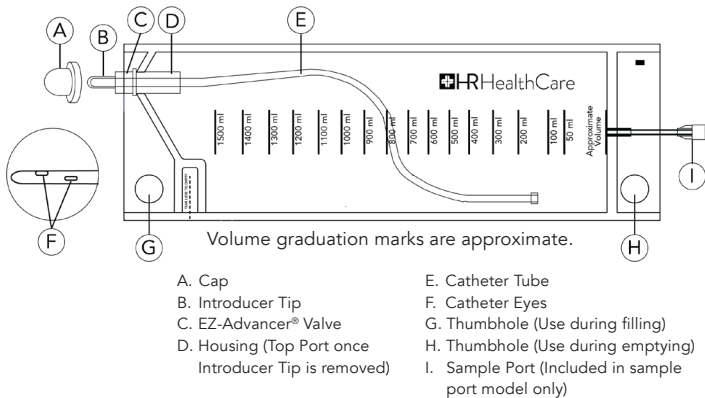

### STEP-BY-STEP INSTRUCTIONS

#### MALE INSTRUCTIONS

(see reverse for female instructions)

- Wash hands. Open the package and remove the contents. Put on gloves, and use an underpad, if necessary.
- Remove outer clothing and underwear to prepare for catheterization.
- Prepare the catheter: Remove the cap from the introducer tip. Ensure that the catheter tube is inside the introducer tip but not extended through the opening of the tip. Set the catheter aside.  
**IMPORTANT:** When removing the cap, gently pry the cap away from the introducer tip. Do not pull the cap in an upward motion to remove it from the introducer tip, as this can cause the introducer tip to be removed from the bag. Ensure the introducer tip is intact after cap removal and still attached to the bag. If you remove the introducer tip during cap removal, discard the entire product and get another. Do not attempt to insert the catheter without the introducer tip attached to the bag. Also, be careful not to touch the introducer tip with your fingers; doing so will compromise sterility.

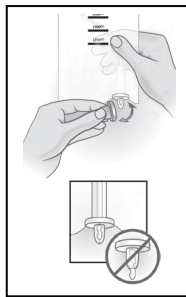

- Starting at the meatus, use a cleansing swab/wipe to gently wipe the glans (head of the penis) in one circular motion. Or, if using swabsticks, start at the meatal opening and circle the swabstick tip around the glans. Use the swabsticks one by one to repeat the same cleansing step for all three swabsticks.
- Hold the penis, just below the glans, with the left hand. With the right hand, grasp the catheter tube through the bag, about one inch (1") below the housing. In the example shown, the user is right-handed. If the user is left-handed, reverse the procedure.
- Insert the catheter and introducer tip into the meatal opening. If using a coude tip catheter, see the note below; otherwise, move to step 7.

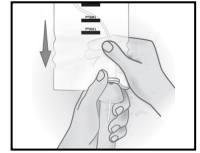
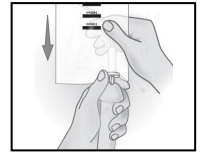
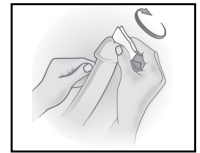

**NOTE:** Coude Tip - A blue indicator line on the catheter tube or a raised line on the side of the colored funnel denotes the location of the curve of the tip. In most cases, the curve of the tip should be in an upward position during insertion to allow the catheter tube to pass beyond the prostate – check with your physician/healthcare provider.

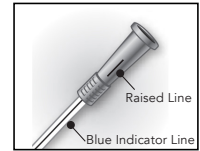

- Begin advancing the catheter into the urethra at 1" to 1.5" intervals. Continue advancing until the catheter reaches the bladder and urine begins to flow.
- Continue to hold the bag during drainage through the finger hole. The EZ-Advancer valve will keep the catheter from retracting back into the bag.
- When the urine drainage is complete, slowly and gently withdraw the introducer tip and the catheter from the urethra.

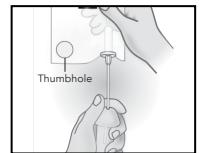
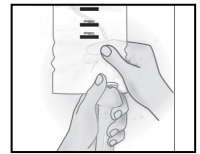

- Next, prepare the catheter for urine disposal. To obtain a sterile sample, follow the **Sterile Sample Collection** instructions below. For standard disposal, tear the bag open where it says, "TEAR HERE TO EMPTY." Tear downwards for best results. Urine can also be disposed of directly from the introducer tip - simply use the thumbhole at the bottom of the bag to position the bag for the urine to flow out of the tip. A third option to empty the bag is to remove the catheter from the collection bag: use a gauze pad or toilet paper to cover the eyes (holes) and grasp the catheter tube. Extend the tube out of the bag until it stops. With the non-dominant hand, grasp the housing firmly. Using the other hand, with a firm tug, pull the tube, introducer tip, and the EZ-Advancer valve completely out of the bag, as shown.

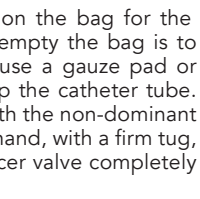
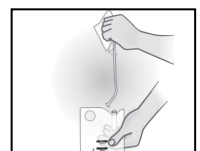

#### Sterile Sample Collection

- EZ-Advancer model without a sample port** (refer to the Catheter Components diagram): First perform hand hygiene and put on new gloves. Remove the introducer tip and pour urine from the top port. If needed, transfer the specimen to a facility-approved container and label it according to hospital/facility policy. Make sure to indicate the date and time the culture was collected, and prepare the specimen for transport per facility policies for specimen handling.

**Instructions continue on reverse.**

- **EZ-Advancer model with a sample port** (refer to the Catheter Components diagram): First, perform hand hygiene and put on new gloves. Scrub the sample port with a disinfectant wipe. Use aseptic technique to collect the specimen using a facility-approved collection device. The EZ-Advancer sample port is a female luer connection and is compatible with standard, luer lock syringes or devices for urine collection. If needed, transfer the specimen to a facility-approved container and label it according to hospital/facility policy. Make sure to indicate the date and time the culture was collected, and prepare the specimen for transport per facility policies for specimen handling.

11. Pour the urine into the toilet or other acceptable waste container. Always dispose of the catheter, bag, and contents using normal, acceptable clinical practice. After use, this product may be a potential biohazard. Handle and dispose of in accordance with accepted medical practice and applicable laws and regulations.



12. Remove gloves (if applicable) and perform hand hygiene.



## FEMALE INSTRUCTIONS

1. Wash hands. Open the package and remove the contents. Put on gloves, and use an underpad, if necessary.



2. Remove outer clothing and underwear to prepare for catheterization.

3. Prepare the catheter: Remove the cap from the introducer tip. Ensure that the catheter tube is inside the introducer tip but not extended through the opening of the tip. Set the catheter aside.

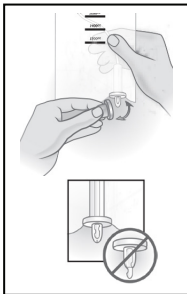

**IMPORTANT:** When removing the cap, gently pry the cap away from the introducer tip. Do not pull the cap in an upward motion to remove it from the introducer tip, as this can cause the introducer tip to be removed from the bag. Ensure the introducer tip is intact after cap removal and still attached to the bag. If you remove the introducer tip during cap removal, discard the entire product and get another. Do not attempt to insert the catheter without the introducer tip attached to the bag. Also, be careful not to touch the introducer tip with your fingers; doing so will compromise sterility.

4. Using the non-dominant hand, spread the labia using the index and middle finger. In the example shown, the user is right-handed, so the labia is spread using the left hand. Cleanse the meatal opening and surrounding labia. If using a cleansing swab/wipe, start at the meatus and swipe downward. If using multiple swabs/wipes, start at the meatal opening and swipe downward. Use the swabs/wipes one by one to repeat the same cleansing step for all swabs/wipes. After wiping, continue to hold the labia apart.

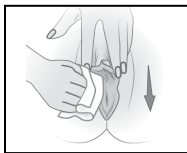

5. Grasp the bag and the catheter an inch (1") below the housing. Insert the catheter and introducer tip into the urethra. Hold the bag as shown to fill properly.



6. Advance the catheter into the urethra with short repetitive motions. Continue advancing until the catheter reaches the bladder and urine begins to flow. The EZ-Advancer valve will keep the catheter from retracting back into the bag.

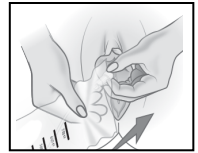

7. Continue to hold the bag during drainage.

8. When the urine drainage is complete, slowly and gently withdraw the introducer tip and the catheter from the urethra.

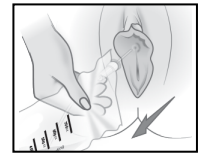

9. Next, prepare the catheter for urine disposal. To obtain a sterile sample, follow the **Sterile Sample Collection** instructions below. For standard disposal, tear the bag open where it says, "TEAR HERE TO EMPTY." Tear downwards for best results. Urine can also be disposed of directly from the introducer tip - simply use the thumbhole at the bottom of the bag to position the bag for urine to flow out of the tip. A third option to empty the bag is to remove the catheter from the collection bag: use a gauze pad or toilet paper to cover the eyes (holes) and grasp the catheter tube. Extend the tube out of the bag until it stops. With the non-dominant hand, grasp the housing firmly. Using the other hand, with a firm tug, pull the tube, introducer tip, and the EZ-Advancer valve completely out of the bag, as shown.

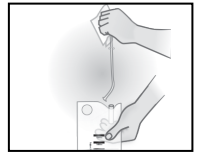

### Sterile Sample Collection

- **EZ-Advancer model without a sample port** (refer to the Catheter Components diagram): First perform hand hygiene and put on new gloves. Remove the introducer tip and pour the urine from the top port. If needed, transfer the specimen to a facility-approved container and label it according to hospital/facility policy. Make sure to indicate the date and time the culture was collected, and prepare the specimen for transport per facility policies for specimen handling.
- **EZ-Advancer model with a sample port** (refer to the Catheter Components diagram): First, perform hand hygiene and put on new gloves. Scrub the sample port with a disinfectant wipe. Use aseptic technique to collect the specimen using a facility-approved collection device. The EZ-Advancer sample port is a female luer connection and is compatible with standard, luer lock syringes or devices for urine collection. If needed, transfer the specimen to a facility-approved container and label it according to hospital/facility policy. Make sure to indicate the date and time the culture was collected, and prepare the specimen for transport per facility policies for specimen handling.

10. Pour the urine into the toilet or other acceptable waste container. Always dispose of the catheter, bag, and contents using normal, acceptable clinical practice. After use, this product may be a potential biohazard. Handle and dispose of in accordance with accepted medical practice and applicable laws and regulations.



11. Remove gloves (if applicable) and perform hand hygiene.



Manufactured for: HR HealthCare  
2600 Eastern Boulevard, Suite 201  
York, PA 17402 USA • hrhealthcare.com



hrhealthcare.com/symbolsglossary

HR HealthCare, the HR HealthCare logo, and EZ-Advancer are trademarks or registered trademarks of HR HealthCare.  
© 2008-2026 HR HealthCare. All rights reserved.

LBL-0074-EN Rev. 4 (05/2026)